



“GL”

Garage Lighter



15” High x 15” Wide
Conical lens is 11” high
bronze body is 4” thick.

MH50, 70, 100, 175 or
HPS50, 70, 100, 150W
Multitap ballast includes
major brand lamp.

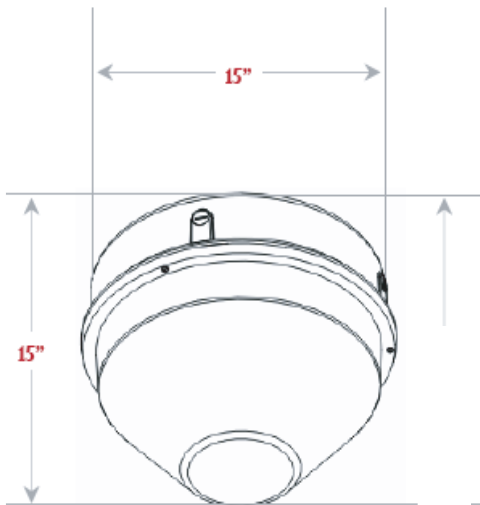

CONSTRUCTION

- Die Cast Back Housing with Built-In Template for Mounting to an Electrical Box
- Chromate Conversion Coating
- Textured Bronze Finish
- Coin Plugs on Side and Back
- Extended Vandal Resistant Polycarbonate Lens
- Stainless Steel Screws, Gasket, Reflector, Pulse Start Medium Base Socket & Bracket
- Vertical lamp Mount

APPLICATION

- Ideal for Security and Perimeter Lighting
- For Warehouse, Schools, and Loading Docks
- Commercial, Industrial, and Institutional Lighting

MH Part Number

GLMH50MTMED
GLMH70MTMED
GLMH100MTMED
GLMH175MTMED

HPS Part Number

GLHPS50MTMED
GLHPS70MTMED
GLHPS100MTMED
GLHPS150MTMED

**major brand lamps included
in all “GL” fixtures**