

300 Series Wraparound

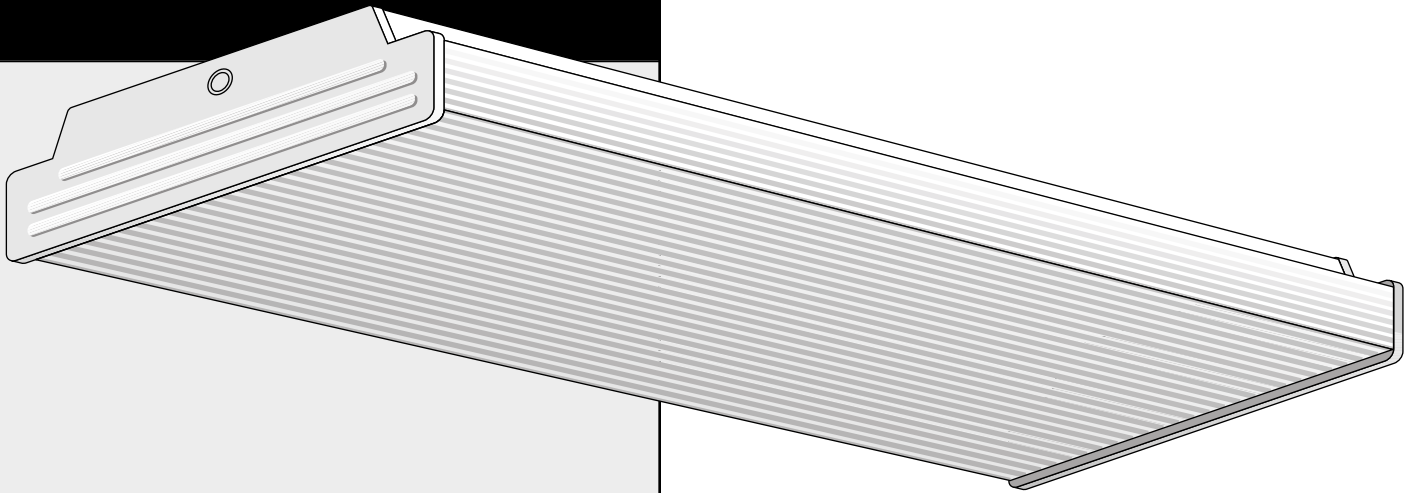
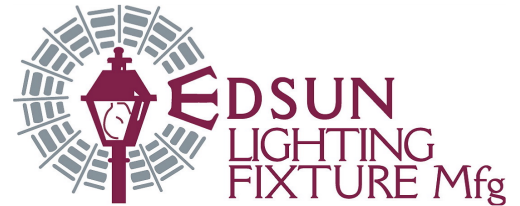

GENERAL DESCRIPTION

A low-profile 2- or 4-lamp wraparound for use with one-piece prismatic lenses.

SPECIFICATIONS

Housing: Die-formed heavy gauge steel with side flanges for extra uniformity and rigidity.

Ballast Cover: Snaps into housing to cover ballast and wires.

Socket Plates: Slide on, for easy wiring.

Ends: Embossed for rigidity. Can be ordered with cut down ends for reverse-form puffs.

Finish: All parts have a baked white enamel finish with 87% reflectivity.

Diffuser (not included) Fixture is designed for one-piece prismatic lenses. Diffusers snap on for easy servicing and hinge from either side. 6' and 8' units require two individual diffusers joined with a plastic strap.

Mounting: Units may be surface or stem mounted, individually or in continuous rows.

NOTES

Dimensions subject to change without notice.

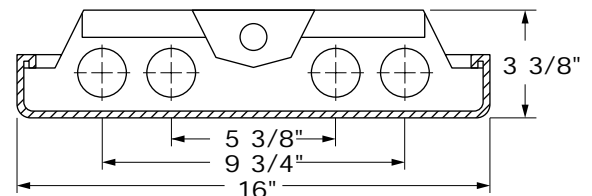
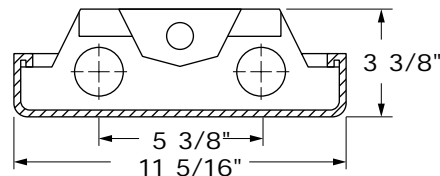

ORDERING INFORMATION

Catalog No.	Lamps	Length
300-220	2	24"
300-217	2	24"
300-240	2	48"
300-232	2	48"
300-2240	4-4'	96"
300-2232	4-4'	96"
300-296	2	96"
300-296T8	2	96"
300-420	4	24"
300-417	4	24"
300-440	4	48"
300-432	4	48"
300-4240	8-4'	96"
300-4232	8-4'	96"
300-496	4	96"
300-496T8	4	96"